

G016847

Base Adapter **IP-ADAPT SCI**

Part no. 5100776-00A

System: TERRA FIRE, TERRA ONE

General Description

IP-ADAPT SCI is an adapter for IP-BASE (part no. 5100774).

IP-ADAPT SCI provides short circuit protection in the detector base.

The SCI is an electronic (-) negative controlled loop switch. Its function is fully automatic and does not require any settings in the configuration. The maximum number of none-SCI units installed to the next SCI (or DSCI) is 32. For examples see [Typical use](#).

Smoke, heat, and flame detectors can be connected to this adapter.



NOTE!

For more information about suitable bases and detectors, see separate document "Base matrix".

Features and benefits

- Installation in harsh environments ¹
- Quick and safe short circuit isolation
- Small Form Factor

Data

Operating voltage range	22-38 V DC
Quiescent current	60 μ A
Current when short circuited	13 mA
Ingress protection	IP66/IP67 (mounted on base)
Operating temperature	-40 °C to +70 °C
Ambient humidity	0 to 95% RH (non-condensed)
Cable terminals	2.5 mm ²
Material	PA66 + FR
Weight	150 g \pm 5%
Minimum sw open voltage (V _{so min})	8 V DC
Maximum sw open voltage (V _{so max})	12 V DC
Minimum sw close voltage (V _{sc min})	14 V DC
Maximum sw close voltage (V _{sc max})	18 V DC
Maximum line current (I _{c max})	500 mA
Maximum switching current (I _{s max})	800 mA
Maximum leakage current (I _{l max})	13 mA
Maximum switch resistance (Z _{c max})	120 m Ω

Certified according to  2531-CPR-CSP10873

DOP no. 6301924

EN54-17: 2005 / AC: 2007

1) The expected lifetime of the product is affected by its environment

Mounting

The base adapter is attached to the detector base IP-BASE with a bayonet mount. Turn the adapter in a clockwise direction and make sure the snap lock connector (1) snaps in place with a clicking sound.

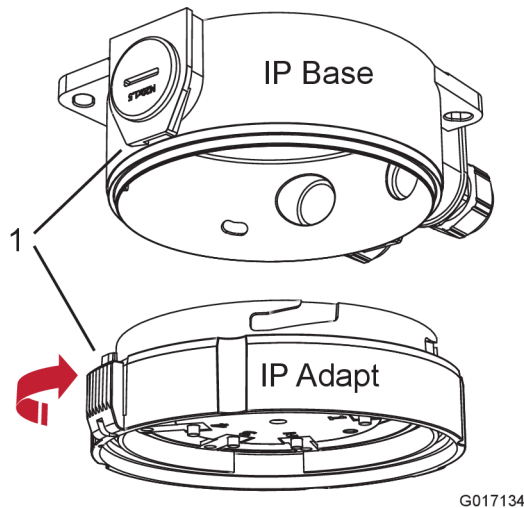

G017134



Hint!

As an option, the snap lock can be further secured with a screw in order to prevent removal of the adapter from the base.

To open the adapter, release the snap lock by pressing it inwards against the adapter; then turn the base in a counterclockwise direction.

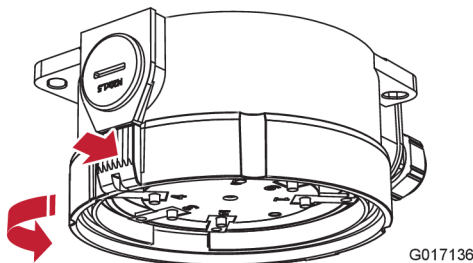

G017136



Hint!

Use a 5 mm screwdriver or similar as a lever; inserting it in the hole (2) to give extra force when turning.

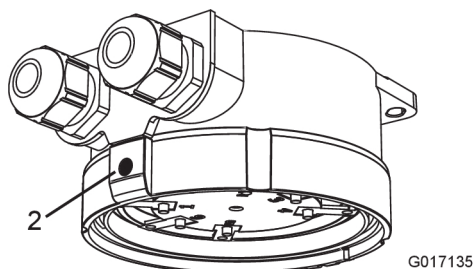

G017135

Securing the detector head

The locking screw (3) secures the base adapter with the detector head. Turn the screw counterclockwise until the screw is level with the rim of the base adapter. See detail with cross-section view below.

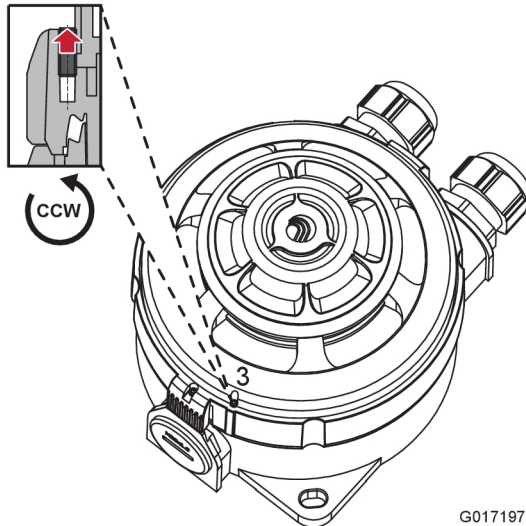

G017197

Connections

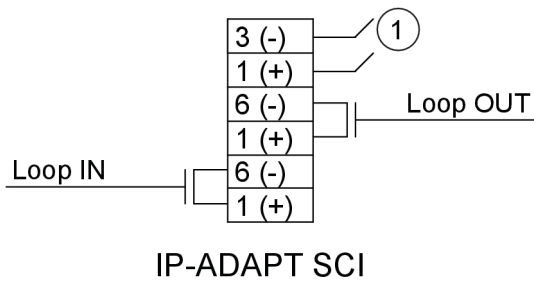

IP-ADAPT SCI

G017133

1. Sounder or remote indicator



NOTE!

All types of detectors do not have the remote output. Please refer to the data sheet for the detector in question.

Typical use

Example 1:

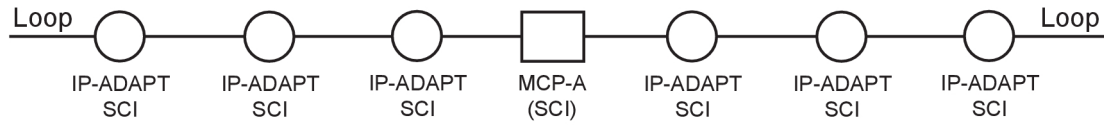

G017290

** = Max 32 detector heads

Example 2:

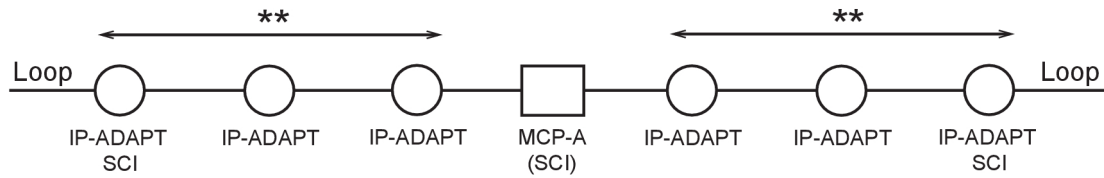

G017292

Dimensions (mm)

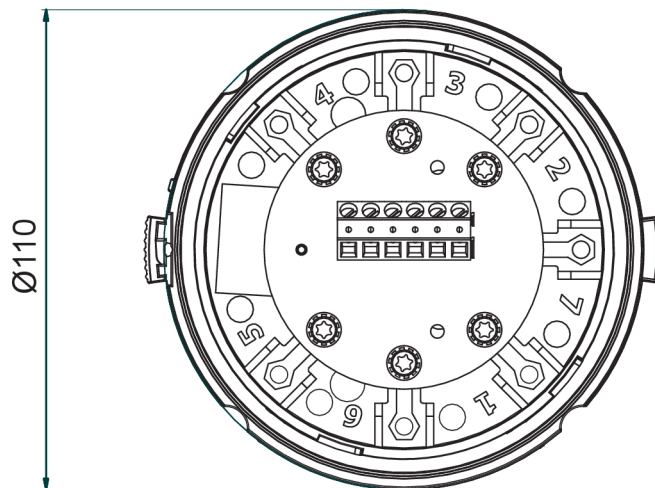
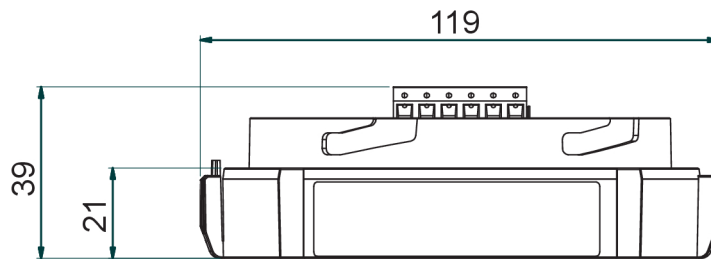

G016853